



สมาคมไฟฟ้าแสงสว่างแห่งประเทศไทย

www.tieathai.org

Illuminating Engineering Association of Thailand (TIEA)

Tel. 0 2935 6905

3rd floor The Engineering Institute of Thailand under H.M.the King's Patronage

Fax. 0 2935 6569

487 Soi.Ramkhamhaeng 39,Phlabphla, Wangthonglang, Bangkok, Thailand 10310

E-mail : TIEA_association@hotmail.com

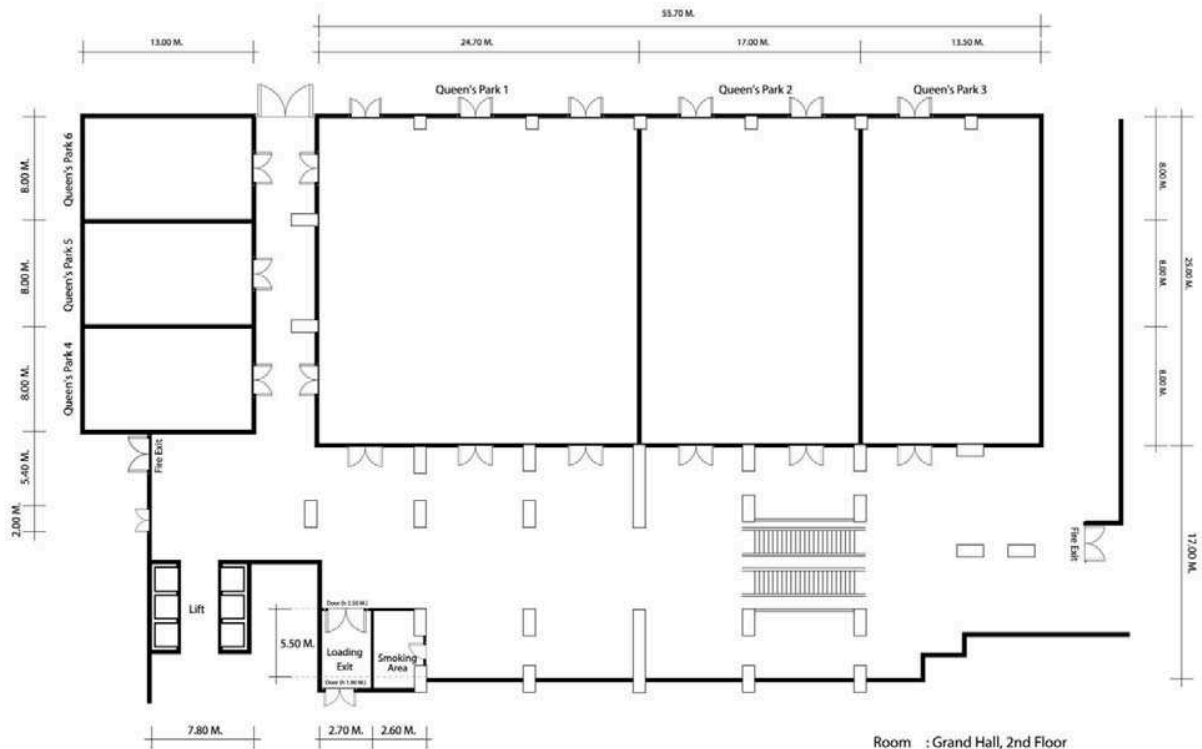
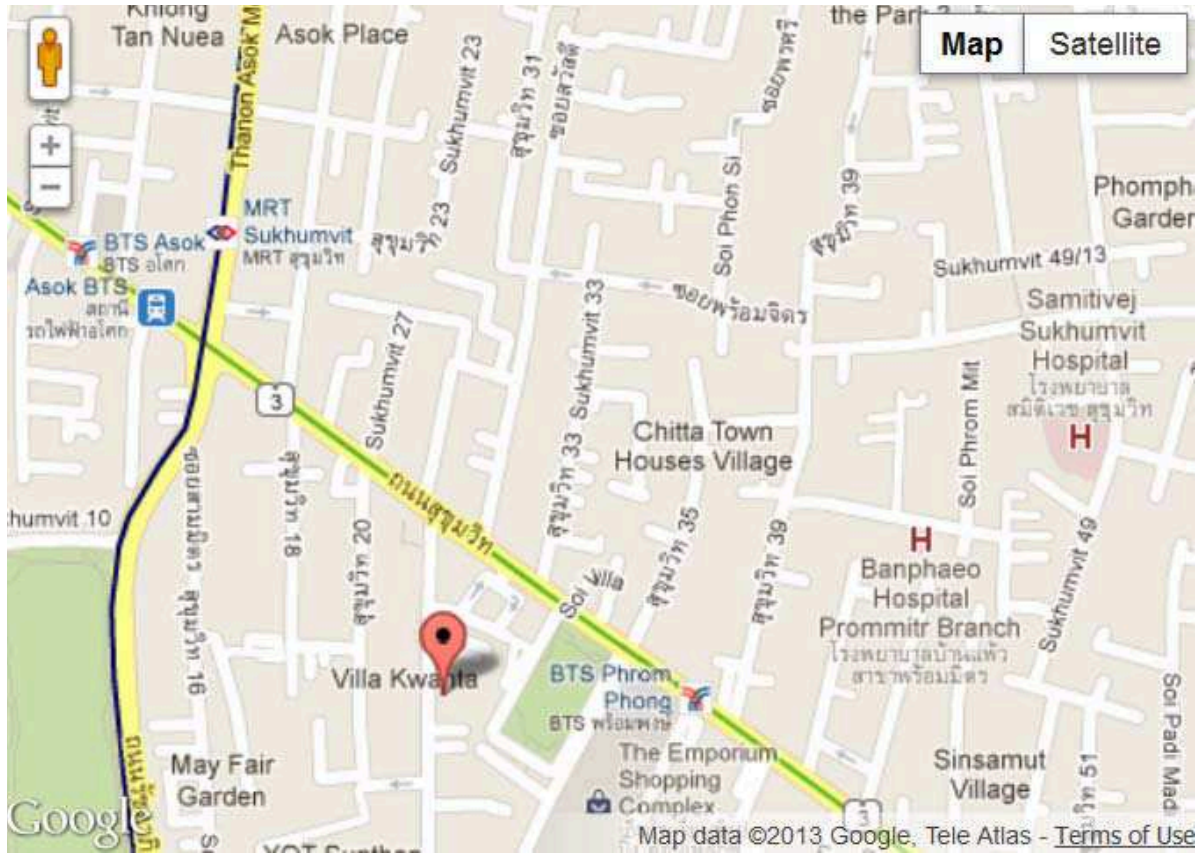

Room : Grand Hall, 2nd Floor
The Imperial Queen's Park Hotel



Schedule

The Imperial Queen's Park Hotel

March 6, 2013

14.00 – 14.30 Light and Culture Forum registration (Free of Charge), limit to 30 persons only, first come first serve, reservation is required.

14.30 - 16.00 Light and Culture Forum/ Discussion at Queen's Park 4 2nd Fl

(Coffee Break)

16.30 – 18.30

Lux Pacifica Board Meeting at Queen's Park 4 2nd Fl

18.30 – 21.00

Welcome Reception at Swimming pool 4th Fl

14.00 – 18.00 PM

The 7th Lux Pacifica 2013 registration in front of Queen's Park 4 2nd Fl

March 7, 2013

08.00 – 09.00

Registration at Queen's Park 3

09.00 – 09.15

Opening Ceremony by **Mr.Utis Chanchenchop** and **Emeritus Professor Warren Julian** at Queen's Park 3

09.15 – 10.30

Keynote speaker 1: Mr.Vincent Laganier

10.30 – 10.50

Coffee Break In front of Queen's Park 3

10.50 – 12.00

Keynote speaker 2: Dr.A. Chutarat, Dr.C. Chuntamara

12.00 – 13.00.

Lunch at Park View Restaurant, Ground Fl.

13.00 – 14.40

Oral presentation Queen's Park 4 and 5

14.40 – 15.00

Coffee Break

15.00 – 16.40

Poster Presentation at Queen's Park 6

Oral presentation at Queen's Park 4 and 5

March 8, 2013

08.00 – 08.45

Registration at Queen's Park 3

08.45 – 10.25

Oral presentation at Queen's Park 4 and 5

10.25 – 10.40

Coffee Break

10.40 – 12.00

Poster Presentation at Queen's Park 6

Oral presentation at Queen's Park 4 and 5

12.00 – 13.00.

Lunch at Park View Restaurant, Ground Fl.

13.00 – 14.40

Oral presentation Queen's Park 4 and 5

14.40 – 15.00

Coffee Break

15.00 – 16.00

Poster Presentation at Queen's Park 6

Oral presentation at Queen's Park 4 and 5

17.00

Bus Pick up for Dinner Cruise (For Full Conference and Accompanying person Registration only)

19.00 – 21.00

Farewell Reception (Dinner Cruise)

21.30

Return to the Imperial Queen's park Hotel